

Transform the patient experience with digital communication.

Effective patient engagement improves the patient experience, increases safety, and reduces cancellations.

From automated patient texting to intuitive patient surveys, HST Patient Engagement provides a web-based solution that is both convenient and easy to use. With HST Patient Engagement, you can:

- **Communicate** with patients in a way that is effective and convenient.
- **Reduce cancellations** by 15% with 2-way patient texting.
- **Send automated text reminders** well before procedures and chat with patients directly.
- **Set auto-response and auto-flagging rules** based on patient responses.
- **Create customized surveys** for all pre- and post-op needs.
- **Improve patient safety** by collecting complete and accurate data.



“We are so excited to have the ability to reach our patients on this level. We pride ourselves on our ability to personalize our patient’s experience to meet their individual needs. HST Case Coordination’s texting functionality allows us to do so in a thoughtful, yet efficient manner.”

- The Center for Minimally Invasive Surgery, Munster, IN

Schedule a demo by scanning the QR code to the right to see how HST Patient Engagement can help grow your practice.



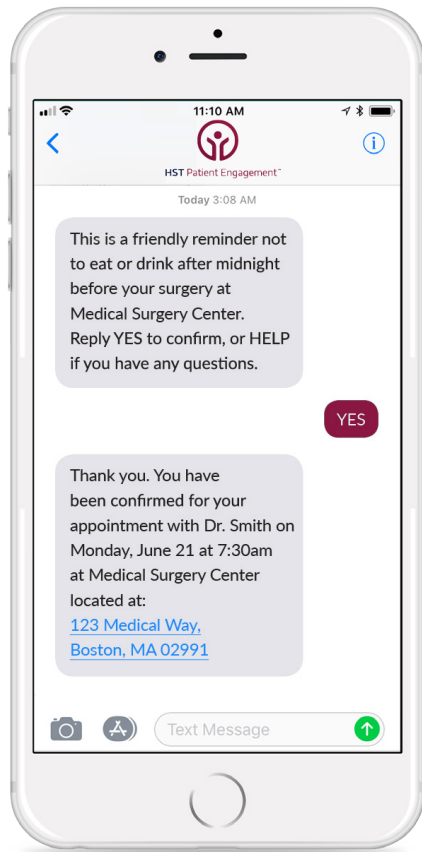

Communicate with patients in a way they prefer: texting.

The patient experience doesn't just start at check-in and end at discharge. HST Patient Engagement's patient texting solution leverages integrated technology to send automated pre-op reminders, post-op check-ins, and more. Improve the patient experience and continuum of care with meaningful engagement through HST Patient Engagement.

Key Features

- Intuitive patient texting
- Rule based auto-responses
- Simple follow-up workflow
- Reduce cancellations & delays
- Rules engine for smart messaging
- Automated patient flagging
- HIPAA compliant
- Improve patient satisfaction

Streamline all the pieces of your pre-assessment process.

Streamline all the pieces of your pre-assessment process in HST Patient Engagement with our powerful pre-assessment and survey tool so your team can spend less time calling patients and more time caring for them.

Key Features

- Clinical risk flags & assessments
- Patient-centric design
- Custom surveys & form builder
- Automated reminders
- Robust management dashboard
- Customized to fit your center's needs

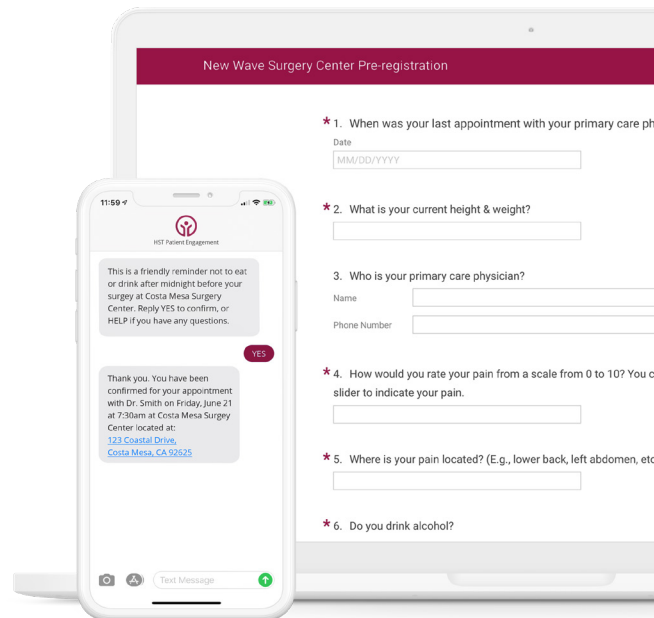

 www.hstpathways.com/hst-patient-engagement

 info@hstpathways.com

 1801 West End Ave, Suite 300, Nashville, TN 37203

